

**PRELIMINARY PLANNED UNIT DEVELOPMENT AND PRELIMINARY PLAT OF SUBDIVISION
FOR
WEATHERSTONE SUBDIVISION**

PART OF THE NORTHEAST QUARTER OF SECTION 12, TOWNSHIP 38 NORTH,
RANGE 9 EAST OF THE THIRD PRINCIPAL MERIDIAN, IN DUPAGE COUNTY, ILLINOIS.

PIN NO.
07-12-216-002
07-12-216-006
07-12-216-022
07-12-216-023

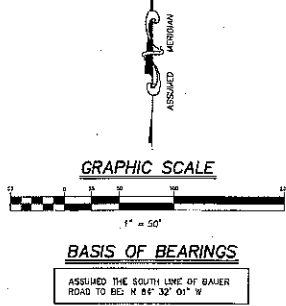
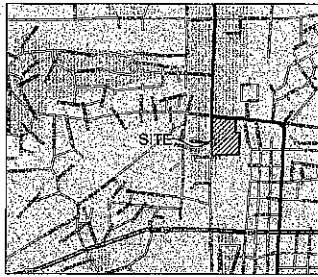

LEGEND		ABBREVIATIONS	
1" = 50'	GRAPHIC SCALE	1" = 50'	GRAPHIC SCALE
...

